

Estimating Framing Materials

Directions:

1. Your instructor will divide the class into groups of three or four.
2. As a group, utilize the methods described in the presentation to estimate the following for the home on the plan provided:
 - Estimate the linear footage of plate material you will need
 - Estimate the number of studs needed
 - be sure to add enough material to build up all framing members
 - Determine the amount of each framing member to be constructed
 - i.e. tees, corners, trimmers, headers
 - Estimate the amount of sheathing needed to cover the outside of the house on the plan provided

Estimating Framing Materials

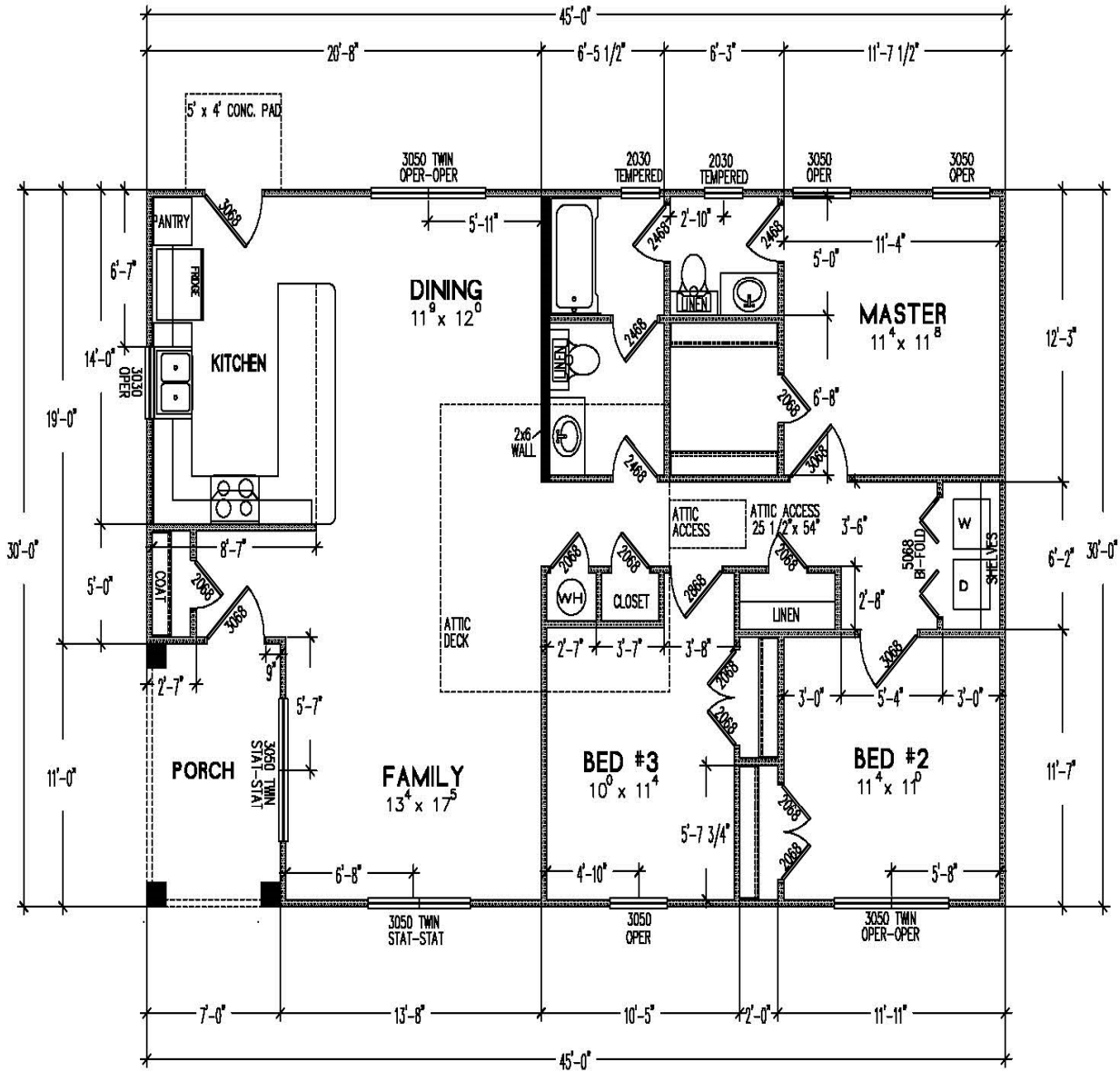

NOTES:
SOLID WALLS
ARE 5 1/2"